

ZA 3500 with COM 3800 dongle manual

4th May 2022

Setup a ZA 3500 with a COM 3800 dongle

- We assume that you know how to install a ZA 3500.
- This manual covers how to connect a ZA 3500 with a dongle (COM 3800) for internet connection.
- More info on the ZA 3500:
<https://www.sensolus.com/tech/infrastructure/za-3500/>

Follow these steps

1. COM 3800 dongle configuration
2. Power the COM 3800
3. Set the network for the ZA 3500
4. LED status indication of COM 3800

COM 3800 dongle configuration

1. Insert the 1NCE SIM card in the USB dongle
2. Write down the GUI password (**WebPwd**) and the WiFi password (**key**)

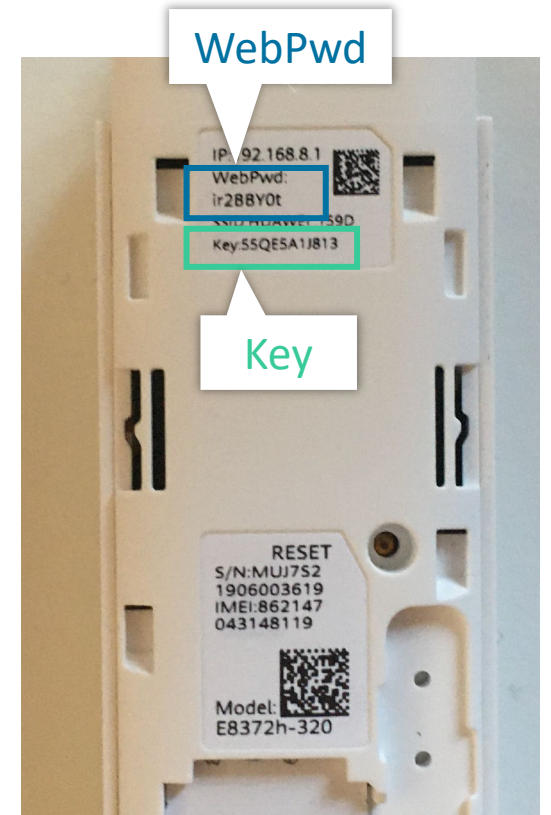

COM 3800 dongle configuration

1. Insert the dongle in your computer
2. Automatically in your browser, the GUI will be opened (192.168.8.1)
3. Change **language** to English
4. Fill in the **WebPwd** en click on **login**



COM 3800 dongle configuration

1. Click Next
2. Click Agree
3. Enable automatic updates, do NOT change the WiFi password and click **Next**.
4. Set **device password** to be the same as Wi-Fi password and click **Finish**

In the home page of the GUI, you see roaming is disabled, enabled roaming

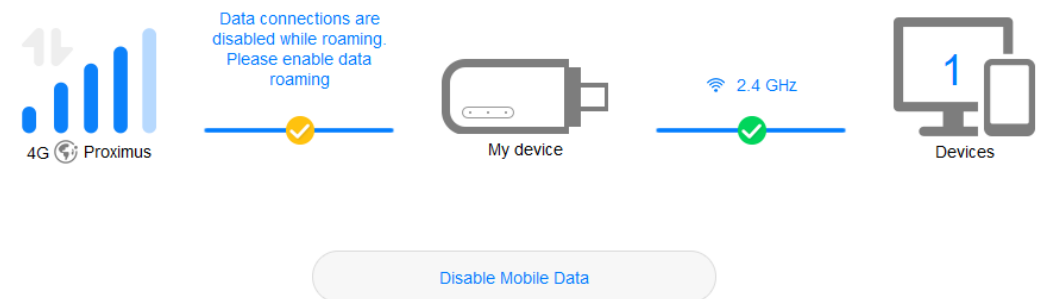
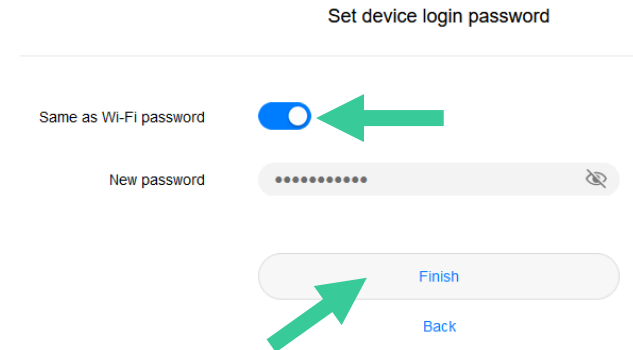

COM 3800 dongle configuration

1. Go to Mobile Network
2. Enable data roaming

In the end you should be able to connect to the WiFi network (password: **key**) and browse the internet

When done remove dongle from your computer.

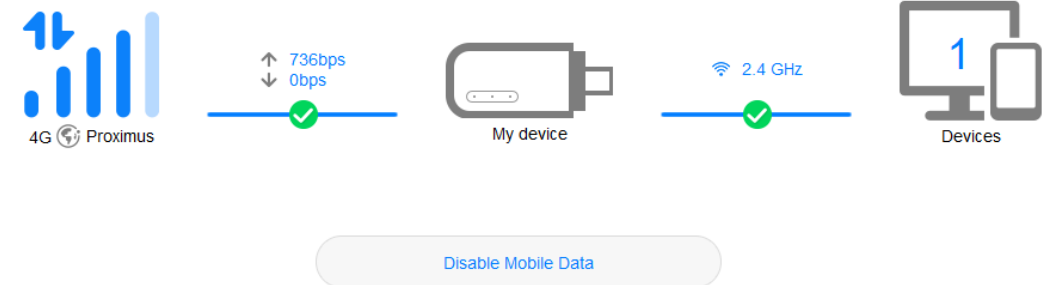
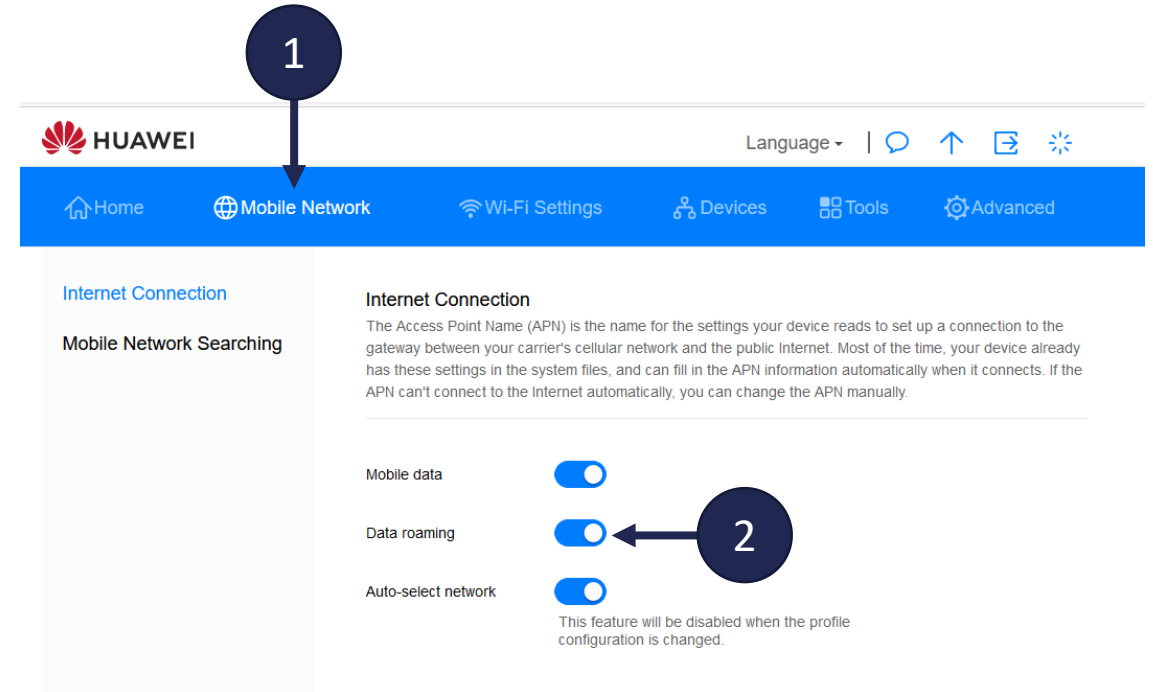

Power the COM 3800

It is highly recommended that the COM 3800 is powered by an usb power adapter.

Using the ZA as a power source is not recommended as this can cause power failure and cause the ZA 3500 to malfunction.



Set the network for the ZA 3500

1. Set to **Wireless**
2. Create new profile: **Huawei**
3. Select **Wi-Fi network HUAWEI_XXXX**
4. Set password to **key**

The screenshot shows the Sensolus network configuration interface. At the top, there are four tabs: Status, Network, Service, and Other. The Network tab is selected. Below the tabs, there are two toggle switches: Ethernet (off) and Wireless (on). Underneath, there is a 'Profile list' section with three entries: 'Huawei (active profile)' (highlighted), 'ap_only', and 'untitled'. Below the profile list is an 'Available Access Point' section with a dropdown menu showing 'HUAWEI_1544'. Below this, there is a text box containing the following information: 'ssid: HUAWEI_1544', 'bssid: 82:10:4F:44:15:E1', 'encryption: WPA2 PSK (CCMP)', 'signal: -42', and 'channel: 11'. Below this text box are four input fields: 'SSID' (containing 'HUAWEI_1544'), 'BSSID' (containing '82:10:4F:44:15:E1'), 'Encryption' (containing 'WPA2-PSK'), and 'Cipher' (containing 'auto'). Below these fields is a 'Key' field with a password mask of ten dots and a visibility icon. Below the key field is a 'Mode' dropdown menu containing 'dhcp'. Below the mode field is a 'Revert to the previous configuration if auth fails' dropdown menu containing 'NO'. At the bottom, there are two checkboxes: 'Hidden property of ssid(failover)' and 'Network checking(failover)'. The Sensolus logo is visible in the top right corner of the interface.

LED status indication of COM 3800

Indicator	LED behavior	Description
Wi-Fi	Steady green	Wi-Fi is turned on
Wi-Fi	None	Wi-Fi is turned off or fails
2G/3G/LTE	Blinking green twice every 2 seconds	Powered on
2G/3G/LTE	Blinking green twice every 0.2 seconds	Software update
2G/3G/LTE	Blinking green once every 2 seconds	Registered to a 2G network
2G/3G/LTE	Steady green	Connected to a 2G network
2G/3G/LTE	Blinking blue once every 2 seconds	Registered to a 3G network
2G/3G/LTE	Steady blue	Connected to a 3G network
2G/3G/LTE	Blinking cyan once every 2 seconds	Registered to a LTE network
2G/3G/LTE	Steady cyan	Connected to a LTE network