

Tracker activation

Trackers are not activated when delivered to your premises, to avoid battery consumption before actual deployment. The tracker is a one-time activation device: once it is activated, it cannot be deactivated afterward.

The activation status can be verified by looking up the device in the Sensolus portal using the device serial number. To effectively start using the tracker, it must be activated using the following method:

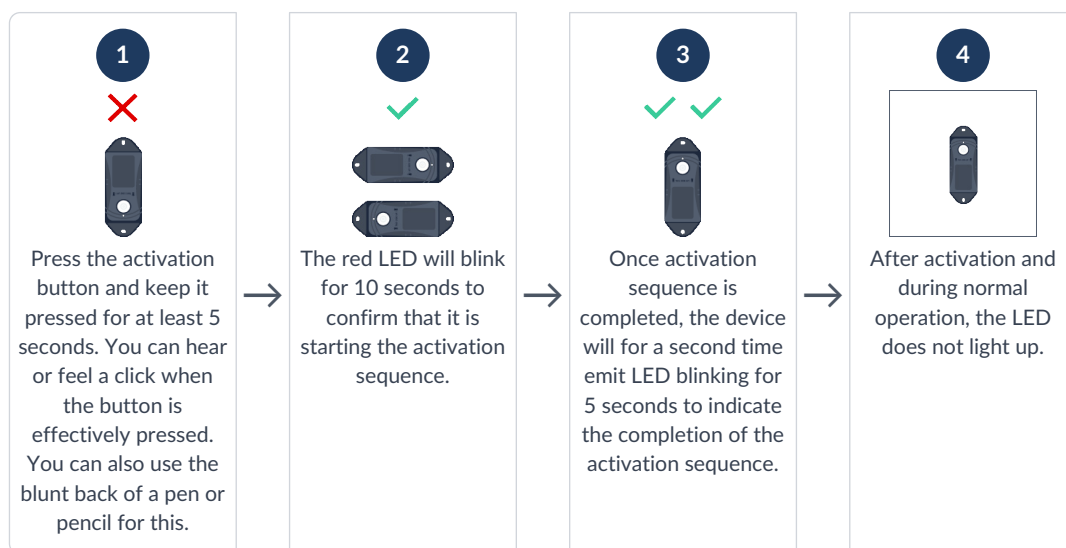

Activation of the tracker is preferably done in a place where there are Wi-Fi networks, which makes it easier to confirm that a first Wi-Fi location resolution has succeeded after activation.

The platform subscription costs for the tracker start when it is first activated, or latest after six months after the shipment date.

In the (exceptional) case that activation sequence cannot be completed within 3 minutes (for example in areas lacking coverage by the communication provider), the device will employ a temporary back-off strategy to avoid draining the battery (2 x 30 minutes, 12 hours and then 24 hours). This means that feedback responsiveness may be reduced when encountering this problem.

Mounting the tracker on the asset

Guidelines how to mount the tracker can be found [here](#).

Recommended device orientation

For optimal battery usage please follow the below device mounting orientation recommendations:

Recommended



Acceptable



Not recommended



Installation advice



Avoid blocking the tracker's view with metal or carbonfibre walls. They weaken or block the radiofrequency signals.



Place the tracker as high as possible on the asset to ensure good network coverage.



Make sure the mounting surface is flat and clean, for a strong and durable bond.



Do not install the tracker on parts that receive frequent shocks or vibrations.



Avoid placing the tracker in a place that can collect water.



If your asset is handled in a rough environment, you can place the tracker in a protected location, but never with metal or carbonfibre above the tracker.